



DOOR HANDLES

Before you start anything, please make a cup of tea and read these instructions fully. If you are in any doubt, STOP and seek professional help. Do not proceed unless you are sure.

Your door handles

Your door handles are designed for interior applications only and are available in various designs. There are two main types of internal frame styles (in circular or square formats), both of which use an 8mm square spindle.

To fit your door handles

1 If not already fitted, mount your chosen lock mechanism into the door using the instructions provided by the manufacturer.

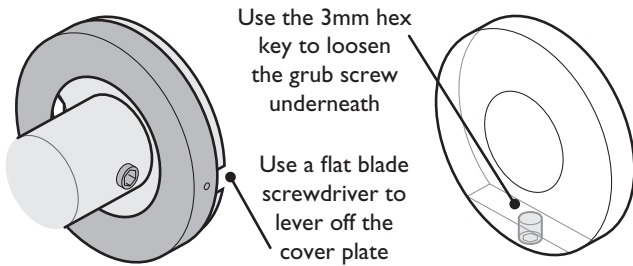

2 Separate the cover plate from the hidden inner frame. The two styles of cover plate (in circular or square formats) have different ways to separate the two parts:

3 Offer up the inner frame to the position it will take on your door. Ensure that the inner frame is centred exactly around where the spindle is (or will be).

4 Mark the mounting holes that you will use. Both styles of inner frames have six holes; you do not usually need to use all of them, however, more fixings can help to make the handles more secure.

Most of our handles are supplied with standard screws plus two through-bolts. The latter provide stronger linking between the inner and outer handles, reducing the risk of a handle becoming loose on the door due to prolonged use. Two different types of through-bolts are available:

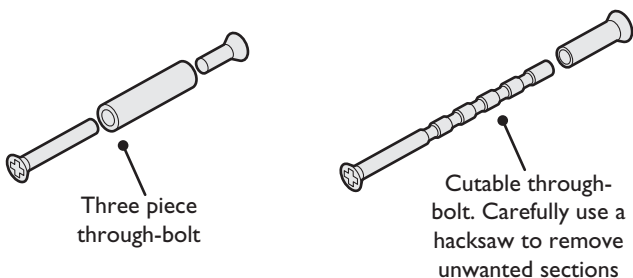

Note: Through-bolts can only be used where the lock mechanism within the door does not obscure the space between the two handles.

5 Carefully drill small pilot holes for the screws and mount the inner frame in place using the supplied screws.

6 Repeat for the other side of the door.

7 Push the spindle through the lock barrel. For narrow doors you can shorten the spindle by carefully sawing off the excess with a hacksaw (also use a file to smooth off any sharp burrs that result from the cut).

8 Fit your door handles to the frames mounted on each side of the spindle and secure them using the supplied hex key. Depending on the style, either push the cover plate onto the inner frame until it wedges into place, or use the supplied hex key to tighten the grub screw located underneath.

