

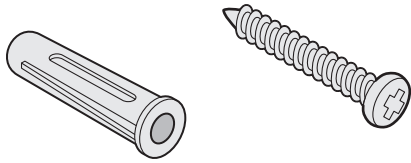

Knurled wall-mounted door stop

Fitting your knurled wall-mounted door stop

Your door stop is supplied with a wall plug and a screw:



Wall plug and screw, suitable for solid (brick) walls or wooden surfaces

1 Check the surface onto which you wish to mount your door stop. The surface needs to be secure, such as a brick wall or solid wooden skirting board. Check for the presence of hidden cabling or piping in the wall.

Note: If you wish to attempt to mount your door stop onto a plasterboard wall then you will need to source a different type of wall plug.

2 Make a mark on the mounting surface at the centre point of where door stop needs to be located.

3 As best suits your mounting surface:

For a brick wall

- Use a 6mm masonry drill bit to create a hole roughly 30mm deep.

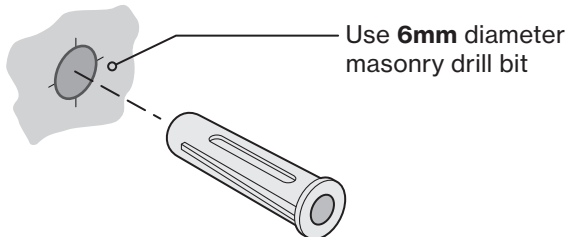

- Insert the supplied wall plug fully into the hole.

For a wooden surface

- Use a 3mm wood drill bit to create a pilot hole roughly 15mm deep.
- There is no need to use the supplied wall plug in a wooden surface - save it for another job.

4 Unscrew and remove the insert from the end of the door stop - the opposite end to the rubber stopper. To do this use any small tapered object, such as a flat blade screwdriver or even nail scissors. Insert your small tapered object into the hole in the insert so that it engages. Turn your chosen object anti-clockwise to encourage the insert to unscrew from the body of the door stop.

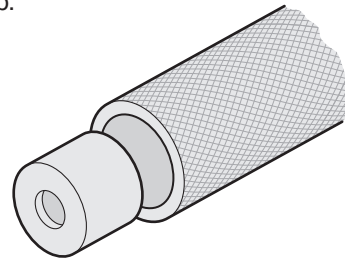

5 Place the large circular backplate of the door stop against your drilled pilot hole (or hole with wall plug in it) and then place the insert against the backplate, so that their holes all align. Insert the supplied screw through the holes and then use a Phillips screwdriver to tighten the screw.

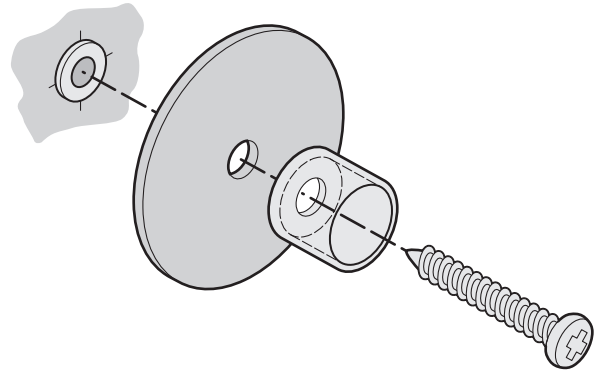

6 Screw the body of the door stop onto the insert until tight.

