



# Decker Picture Light

**WARNING** Never take risks with electrical safety. Always disconnect the mains power before beginning any electrical work and test that it is isolated - it is NOT enough just to turn off the light switch. Electrical products must be installed in accordance with IET regulations (BS 7671). If you are in any doubt, always consult a qualified electrician or an experienced person registered with an electrical Competent Person Scheme. Further information is available online or from your Local Authority. If the lighting circuit is not protected by a Residual Current Device (RCD) then the installation should be carried out and tested by a qualified electrician. If necessary, use a suitable stepladder, but first read the useful advice given by the Health and Safety Executive. Visit [www.hse.gov.uk](http://www.hse.gov.uk) and search for 'using stepladders'.

Before you start anything, please make a cup of tea and read these instructions fully. If you are in any doubt, STOP and seek professional help. Do not proceed unless you are sure. This product must be installed in accordance with local building regulations.

## To fit your Decker picture light

- 1 Shut off power to the circuit and use a tester to ensure power has been completely isolated.

*Note: These lights are not suitable for use in circuits with ratings that exceed 10 Amps.*

- 2 Carefully prepare your picture light:

- Use a crosshead screwdriver to remove the two screws from either side of the main body (D). Then remove the mount bracket (B).
- Rotate the lamp shade (A) through 90 degrees.

- 3 Offer up the mount bracket to the position on the wall where you'd like to mount the light.

**It is vitally important that the screws do not disrupt any cabling behind the wall surface. Take time to properly survey the location.**

- 4 When you have checked for the location of any cables or pipes in the wall, mark two points through the mount bracket.

- 5 For brick walls: Use a drill and an 7mm masonry drill bit to create two holes at your mark points. Then insert the two supplied wall plugs.

For wooden mount points: Use a drill and a 2mm wood drill bit to create two shallow pilot holes at your mark points.

- 6 Place the mount bracket over the holes, then insert and tighten the two supplied screws (M4 x 30mm) - (B).

## Tools you will need:

- Crosshead (Pozidrive or Phillips) screwdriver - size 2
- Small flatblade screwdriver
- Wire strippers or electrician's side cutters
- Drill and masonry drill bit - 7mm diameter

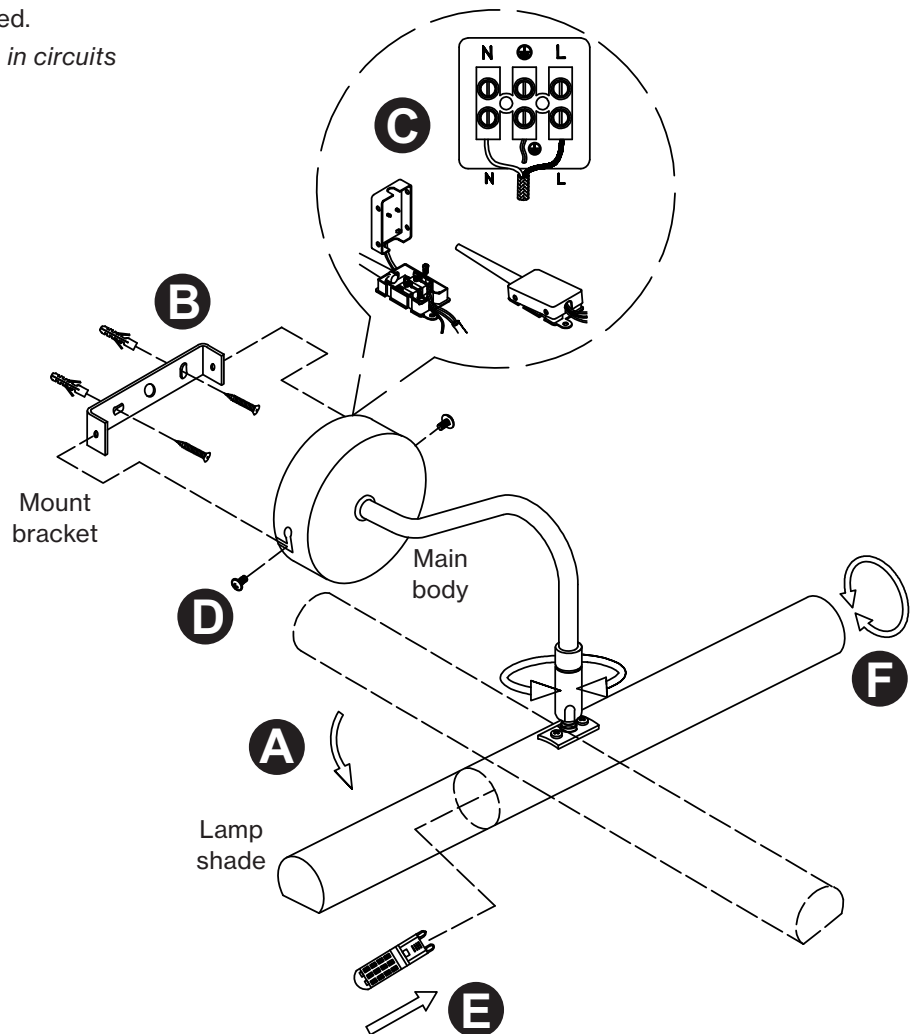

- 7 Locate the incoming mains lighting feed cable - double check that it is completely isolated from the power supply.
- 8 Carefully strip the outer sheath and individual wires of the incoming feed - the bare wire tips should have an exposed length of roughly 7mm. For twin and earth cables, place a suitable length of green/yellow insulation tubing over the bare earth wire so that only 7mm of the tip is exposed.
- 9 Carefully prise open the supplied white connector block **(C)** and then hold the main body of the light near to the incoming feed cable - this is easier if you have assistance.
- 10 Secure the incoming brown **(live)**, blue **(neutral)** and green/yellow **(earth)** wires to match up with the terminals in the box. Once all connections are made, check that they are all correct and secure, then replace the white cover on the box.
- 11 Place the main body **(D)** onto the mount bracket and insert the two screws removed earlier.
- 12 Place the supplied bulb into the holder within the lamp shade **(E)**.
- 13 Restore power to the circuit and switch on the light.
- 14 Carefully tilt the lamp shade **(F)** so that your picture is evenly illuminated.